

**9 ACCESSIBLE PARKING SIGN**  
SCALE: 3/4" = 1'-0"

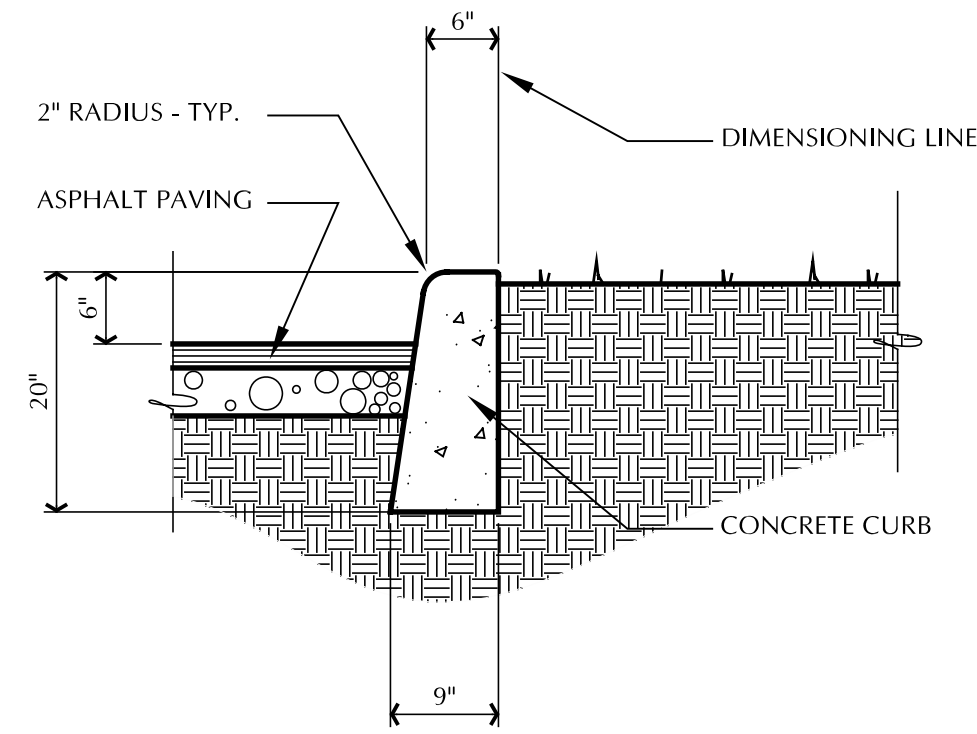

**4 CURB DETAIL**

SCALE: 3/4" = 1'-0" 03120-06

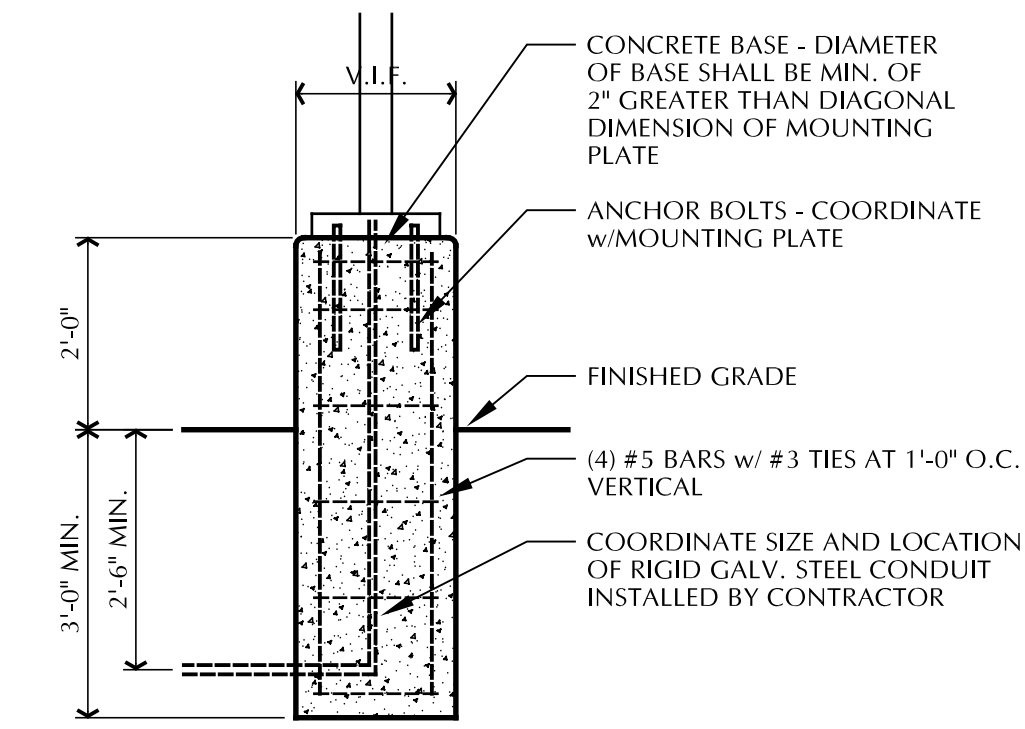

**8 LIGHT BASE**

SCALE: 1/2" = 1'-0"

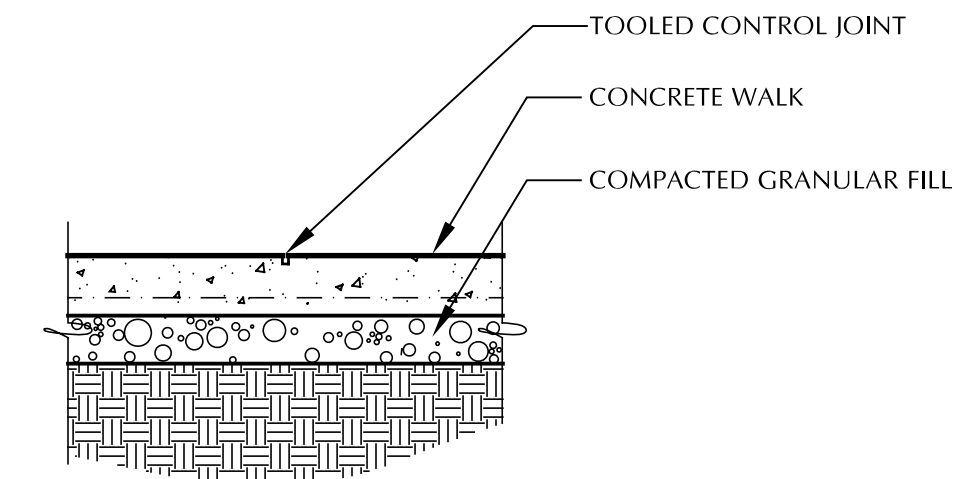

**3 CONTROL JOINT**

SCALE: 3/4" = 1'-0"

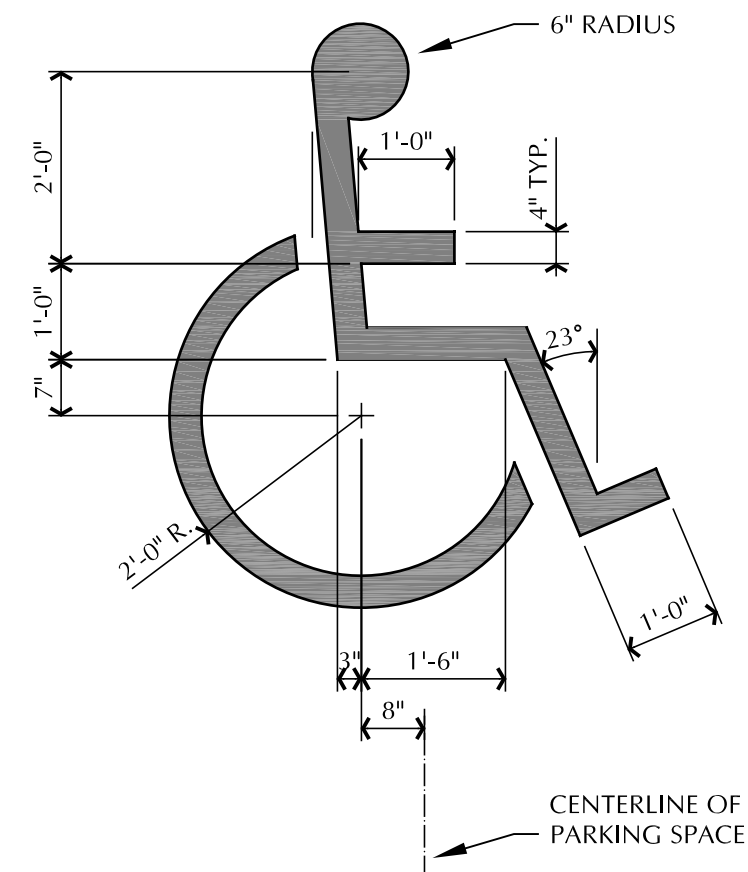

**7 ACCESS. SYMBOL**

SCALE: 1/2" = 1'-0" ADBX-01

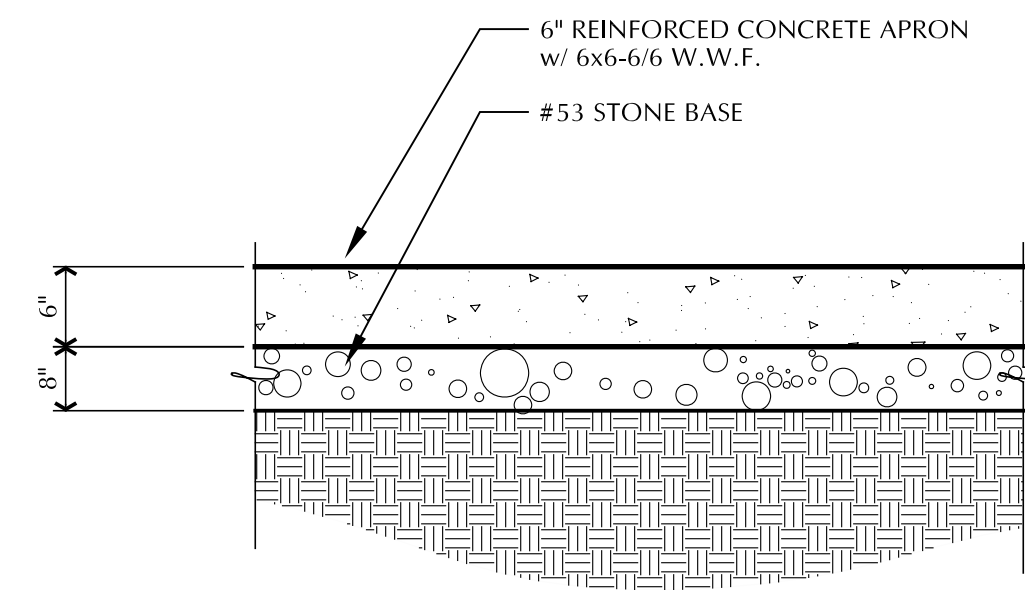

**2 PAVING SECTION**

SCALE: 1" = 1'-0"

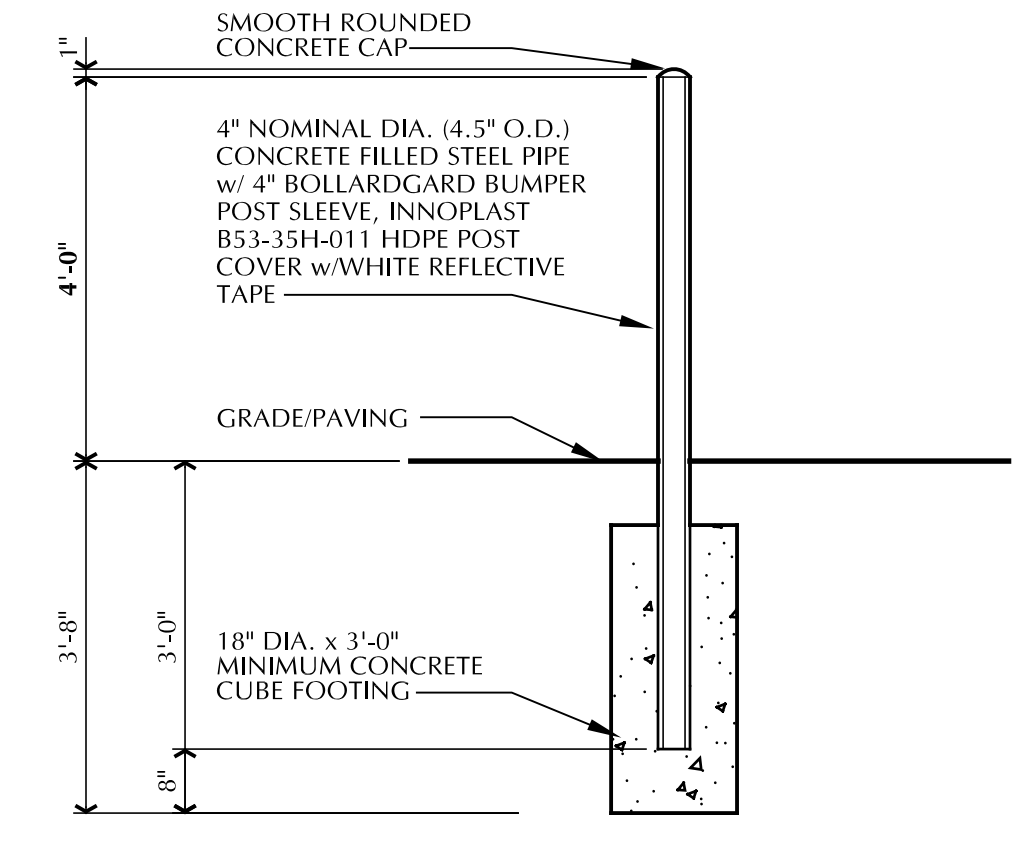

**6 STEEL PIPE BOLLARD**

SCALE: 1/2" = 1'-0"

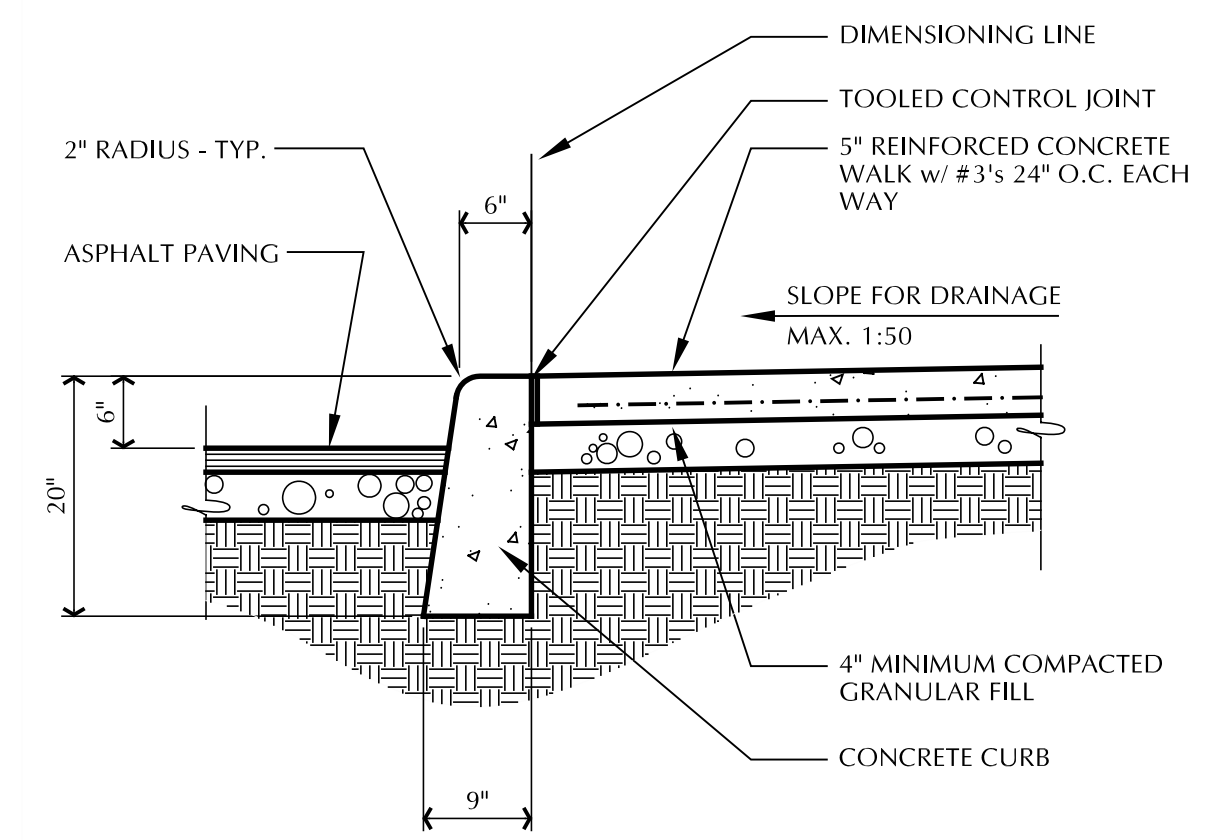

**1 CURB DETAIL (ALT. DET.)**

SCALE: 3/4" = 1'-0"

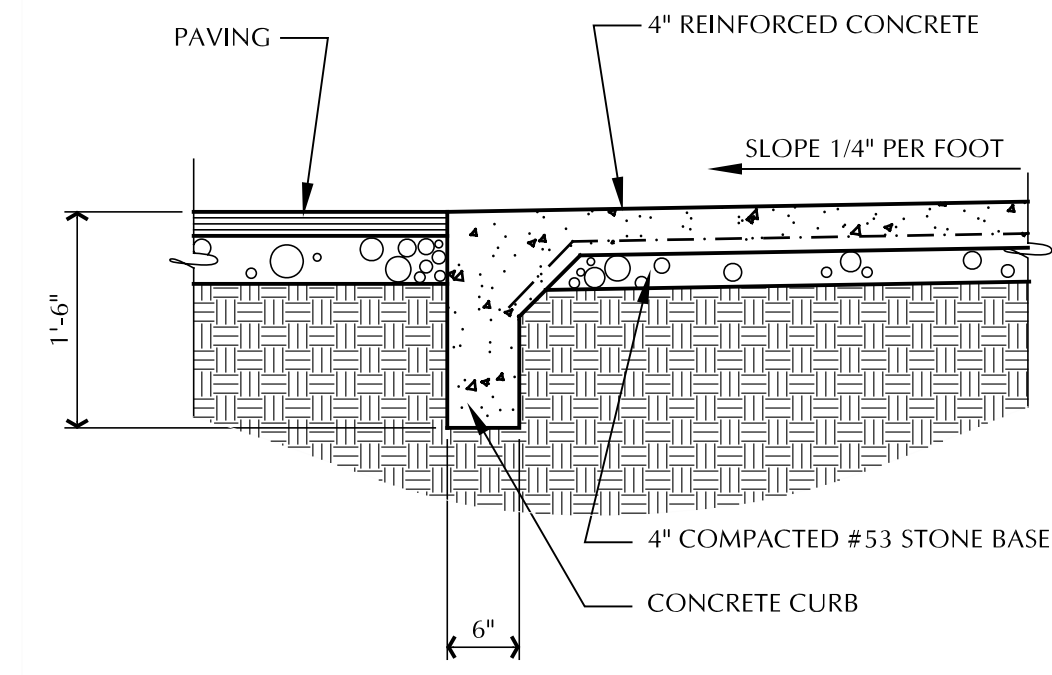

**5 CURB SECTION**

SCALE: 3/4" = 1'-0"

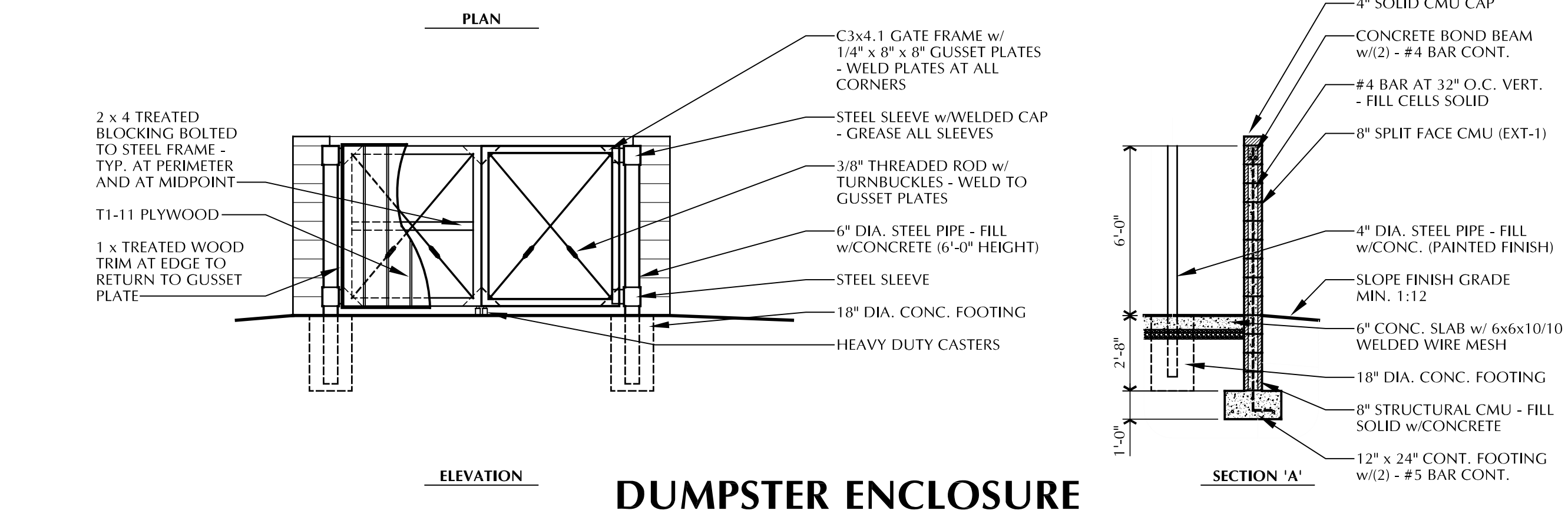
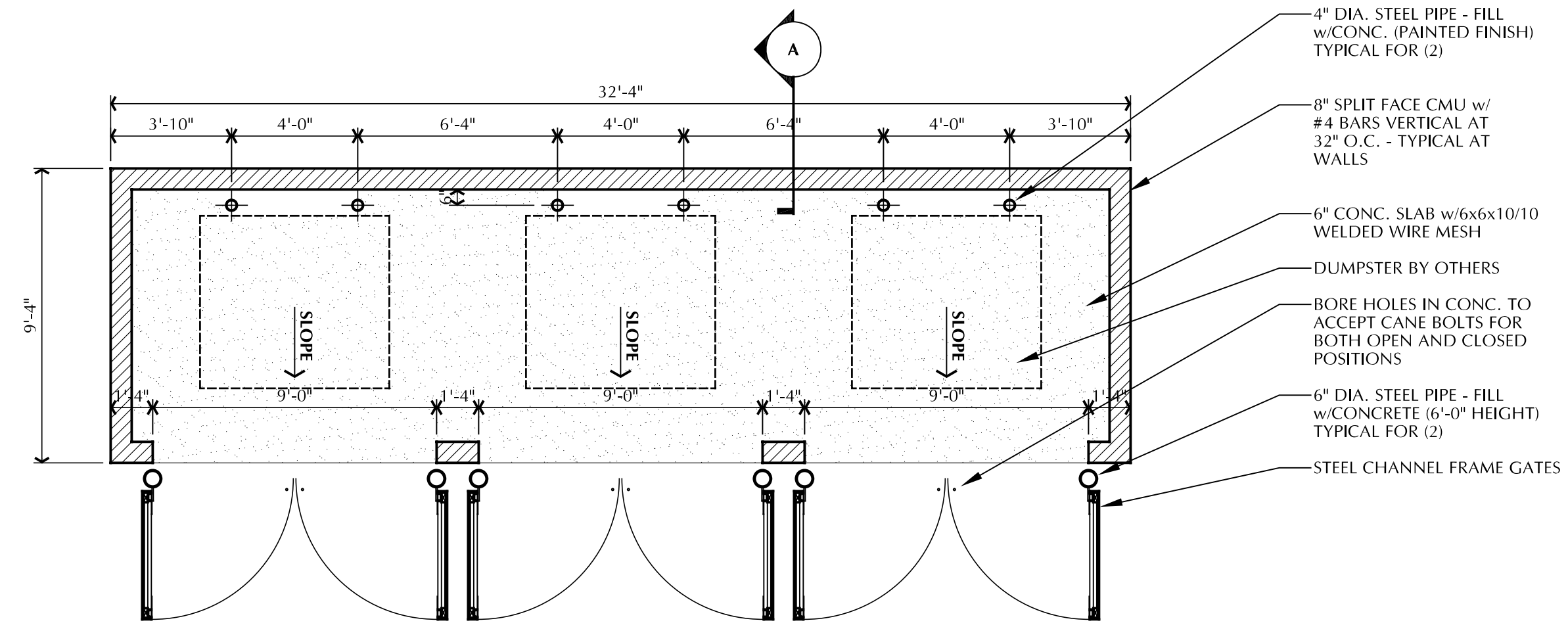

**DUMPSTER ENCLOSURE**

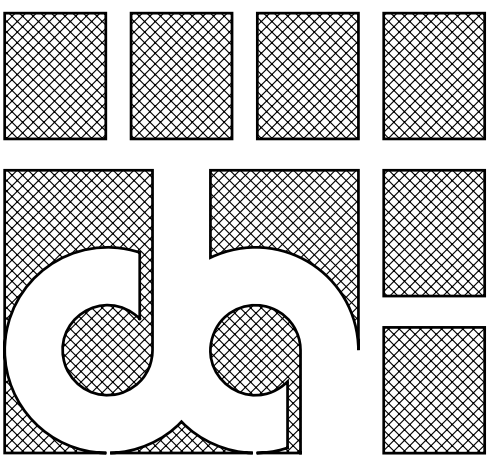

**DAUSS ARCHITECTS**

architecture  
planning  
227 historic w. 11th st.  
p.o. box 1006  
anderson, in 46016  
tel: 765/649-2258  
fax: 765/649-2337  
info@daussarchitects.com

SCOPE OF DRAWINGS  
These Drawings indicate the general scope of the Project in terms of architectural design concept, the dimensions of the building, the major architectural elements and the type of structural, mechanical and electrical systems. The Drawings do not necessarily indicate or describe all work required for full completion and construction of the project. It is the responsibility of the contractor to verify the accuracy and coordination of all dimensions, materials and methods of construction shown on the drawings and to provide the scale construction details. All items not shown on the drawings are to be provided by the contractor.

COPYRIGHT  
DAUSS ARCHITECTS

DRAWN CHECK

DATE  
ISSUED FOR BIDDING, STATE REVIEW,  
AND CONSTRUCTION - JUNE 11, 2008  
ADDED DUMPSTER ENCLOSURE  
JUNE 20, 2008

A  
NEW BUILDING  
**45TH STREET BUILDING**

for  
**SOUTH ANDERSON, LLC**

**ANDERSON, INDIANA**

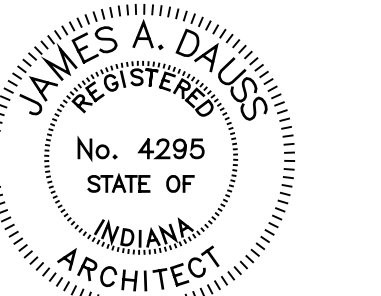

*James A. Dauss*

SHEET TITLE  
**SITE DETAILS**

SHEET NUMBER  
**A103**  
OF SHEETS

PROJECT NUMBER  
**S003-0801**